

GERMANICA

1.9kW

PORTABLE AIR CONDITIONER

GPA19KW



INSTRUCTION MANUAL

Please read this manual carefully before using, and keep it for future reference.

CONTENTS

General Safety	4
Product Overview	9
Accessories List	10
Control Panel	11
Remote Control	11
Installation	12
Window Kit Installation	14
Instructions	
Using the Portable Air Conditioner	15
Cooling Mode	16
Dehumidifying Mode	16
Fan Mode	16
Auto Swing	16
Sleep Mode	16
Timer Operation	16
Water Full Alarm	17
Cleaning and Maintenance	18
Troubleshooting	19
Specifications	Last Page
Customer Helpline	Last Page

GENERAL SAFETY

Read this manual thoroughly before you start using the portable air con.

Store this manual, the completed warranty card, your receipt and the product packaging.

The safety precautions instructions reduces the risk of fire, electric shock and injury when correctly complied to.

Please follow all instructions and take notice of all warnings.

Please follow instruction when installing this product in accordance with the instruction manual. This product must be positioned in a sufficiently stable location, it can be potentially hazardous due to falling when mounted and can cause injury, particularly to children if it positioned incorrectly.

- Before installing this aircon, make sure your outlet voltage corresponds to the voltage stated on the power supply rating label
- Do not use a damaged power cord, plug or loose outlet. Doing so may cause an electric shock.
- If the power cord is damaged, it must be replaced by the manufacturer or a qualified service technician.
- Do not plug several devices into the same outlet. Doing so may cause the outlet to overheat and start a fire. Make sure the outlet is readily accessible during operation of the equipment.
- Do not bend, twist or kink the power cord excessively.
- Do not allow anything to rest on or roll over the power cord.
Doing so may cause a fire or an electric shock.
- Do not run the power cord near heat-producing appliances such as radiators, stoves or irons. The excessive heat could melt the insulation and expose live wires, resulting in fire or electric shock.
- Do not expose the air conditioner to water. The electrical insulation could be damaged and cause electrocution. Do not touch the unit when barefoot or parts of your body are wet or damp.
- This appliance is not intended for use by persons (including children) with reduced physical, sensory or mental capabilities, or lack of experience and knowledge, unless they have been given supervision or instruction concerning use of the appliance by a person responsible for their safety.
Children should be supervised to ensure that they do not play with the appliance.
- If the supply cord is damaged, it must be replaced by the manufacturer, its service agent or similarly qualified persons in order to avoid a hazard.
- This appliance is intended for air conditioning indoor domestic environments. It is not suitable for commercial, industrial or trade use. Do not use it for any other purpose (such as drying clothes, cooling food, etc.), and only use it as described in this manual. Working environment temperature range 18°C-35°C.

GENERAL SAFETY INSTRUCTIONS (Cont.)

- Do not cover the ventilation openings of the product with items such as newspapers, tablecloths, curtains etc or insert objects into the slots available on the products. As this could result in the product temperature rising and could cause a fire.
- If you notice any unusual odors or smoke around the unit, immediately disconnect the unit from the outlet and contact the service center. Failure to do so may result in fire or electric shock.
- When not using the unit for long periods of time or when you are moving the unit please ensure to disconnect the power supply from the wall socket.
- Please beware that Dust could accumulate over time on the unit and cause it to generate heat and or deteriorate insulation, which in turn may result in an electrical fire.
- The product is not intended for use by persons (including children) with reduced physical, sensory or mental capabilities, or young children of any age, They must be supervised by a person responsible for their safety.
- Batteries from the remote control must be only removed by an adult, the adult must ensure to keep them out of reach of infants and children. Seek medical attention immediately if a child has swallowed a battery.
- To maintain the product do not use any chemical or cleaning agent or wet cloth, please only ensure to utilize a dry cloth to wipe it down from marks or dust and only after unplugging the product from the power socket.
- Always use the air con with the air filter mounted. Using it without the air filter can cause accumulation of dust or waste on the inner parts of the device with possible subsequent failters.
- Do not direct airflow directly onto plants or animals, as long exposure can affect them.
- Please ensure to contact our call center for any repair or service required for the products not doing so will make warranty on your product void.
- We assume not liability for any eventual damages to property or injury to persons caused by misuse of the product or noncompliance with these instructions.

Please make sure upon positioning this product, the place is:

- Not wet or damp and Well ventilated
- Away from direct sunlight or heaters.
- Away from splashes or food.
- Protected from excessive dust or grease.
- Do not place containers with liquids, if liquid falls inside the products it may result in short-circuit, fire or electric shock.
- Do not place small metallic objects on top of the unit or block the openings as it will reduce operating efficiency of the air con with failures or damages.

GENERAL SAFETY INSTRUCTIONS (Cont.)

- This appliance is intended for air conditioning indoor domestic environments. It is not suitable for commercial, industrial or trade use. Do not use it for any other purpose (such as drying clothes, cooling food, etc.), and only use it as described in this manual.
- Do not use the unit outdoors. It is for indoor use only.
- This appliance is not intended for use by persons (including children) with reduced physical, sensory or mental capabilities, or lack of experience and knowledge, unless they have been given supervision or instruction concerning use of the appliance in a safe way and understand the hazards involved.
- **WARNING: Do not cover!** Do not cover the air conditioner or obstruct any air inlet or outlet grilles. Obstructing these openings causes a fire hazard, reduces the operating efficiency and may lead to malfunction or damage.
- Do not insert any objects, or your fingers, into the air outlet, and make sure to warn children of the dangers. Keep ventilation openings clear of obstructions.
- Supervise children to ensure they do not play with the appliance. Close supervision is necessary when any appliance is used by or near children. Cleaning and user maintenance shall not be made by children without supervision.

DO NOT INSTALL/USE THE APPLIANCE IN THE FOLLOWING AREAS:

- outdoors or where water is likely to splash
- near a bath, shower, laundry basin or swimming pool
- in an area where oil is likely to splash
- near a hot gas or electric burner, or sources of fire
- near sources of heat, or exposed to direct sunlight
- in an area where furniture or other objects can obstruct the airflow
- in the presence of flammable substances or vapour such as alcohol, insecticides, petrol, etc.
- at a dry cleaner's premises.

R290-SPECIFIC SAFETY ADVICE:



Caution, risk of fire

WARNING: Combustible & Dangerous

This symbol alerts you to take care as the appliance contains a flammable refrigerant: R290 (propane). Take extra care when installing the unit and when carrying out maintenance. R290 is a colourless and odourless hydrocarbon gas. It is an efficient refrigerant with a low Global Warming Potential (GWP) and no potential for ozone depletion.

While R290 is highly flammable, there will be no risk of burning and explosion if the appliance is properly installed and maintained following all instructions and safety advice in the supplied manuals.

GENERAL SAFETY INSTRUCTIONS (Cont.)

- There must be a clearance of at least 30cm between the walls, furniture, curtains or any other obstacles (refer to below image). Maintaining this minimum 30cm clearance is essential; failure to keep that distance can result in the unit malfunctioning or causing injury.
- The air exhaust can be installed in a vertical or horizontal sliding window.
- Keep the length of the air exhaust hose to the minimum length necessary during operation.
- Place the unit on a flat surface to reduce the risk of it tipping over. Do not tilt the unit, always keep it upright during installation and use.
- We accept no responsibility for any eventual injuries or damages caused by improper installation, faulty use or failure to follow the instructions.

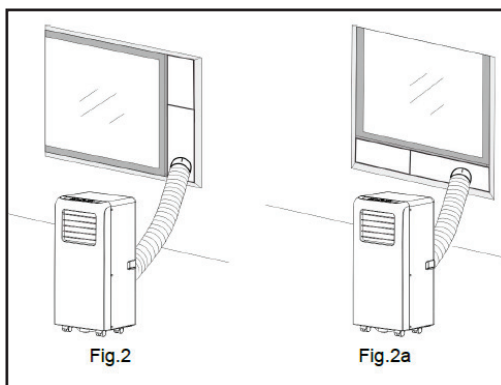
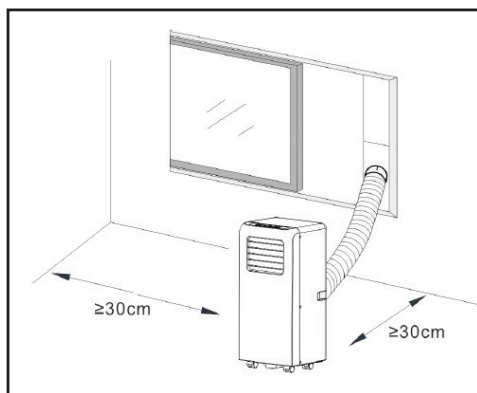

Pressure specifications:

Permissible excessive operating pressure	Discharge 2.6MPa
	Suction 1.0MPa
Maximum allowable pressure	Discharge 3.2MPa
	Suction 1.2MPa

GENERAL SAFETY INSTRUCTIONS (Cont.)

WARNING:

- Do not expose the appliance to high heat, sparks and open flames.
- Do not pierce or burn the appliance.
- Do not use means to accelerate the defrosting process or to clean, other than those recommended by the manufacturer.
- Be aware that refrigerants may not contain an odour.
- This air conditioner has been fully charged with refrigerant at the factory.
Should a recharge become necessary, it may only be recharged by a professional installer.
- Maintenance must only be carried out by properly qualified, authorised personnel.
If the appliance requires maintenance or service, contact our after sales support centre info@ayonz.com
- **The service technician must strictly comply with:**
 - all safety instructions in the manual provided with the appliance
 - all relevant provisions of gas-related local laws and regulations.

Electric shock hazard!

Before installation, cleaning or or servicing, ensure the unit is switched off and disconnected from the power outlet to prevent possible injury.

PRODUCT OVERVIEW

Portable air conditioner

- 1 Control panel
- 2 Air intake grille with filter
- 3 Cold air outlet with louvre
- 4 Castor wheels
- 5 Power cord and plug connection (cord and plug not shown here)
- 6 Exhaust air outlet for flexible hose connection
- 7 Air intake grille
- 8 Drainage outlet with plug





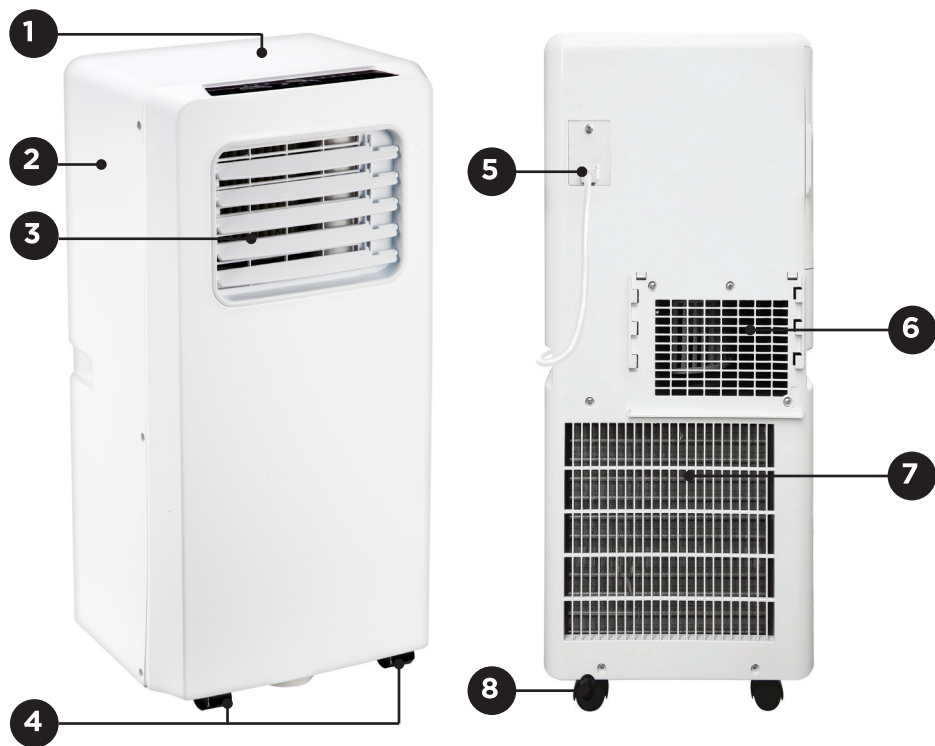

Front & left side view

Rear view



PRODUCT OVERVIEW (CONT.)

ACCSESORY PARTS

Part	Description
	Flexible air exhaust hose
	Exhaust hose connector (window end)
	Exhaust hose connector (housing adaptor) (air conditioner end)
	Remote control
	Adjustable window slider (for 67.5cm – 123cm windows)
	2 Dowels
	2 AAA-size batteries (packaged separately)

PRODUCT OVERVIEW (CONT.)

Control panel

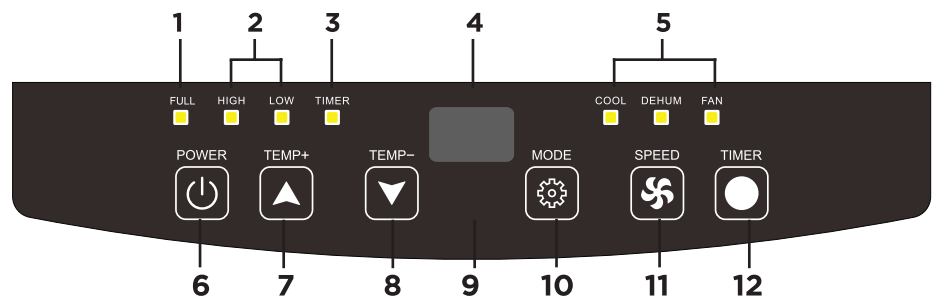

Control panel buttons and indicators

- | | | | |
|---|---------------------------|----|--------------------------------|
| 1 | Water full indicator | 8 | Temperature down button |
| 2 | Fan speed indicators | 9 | Remote control signal receiver |
| 3 | Timer indicator | 10 | Operation mode button |
| 4 | Temperature/timer display | 11 | Fan speed button |
| 5 | Mode indicators | 12 | Timer button |
| 6 | Power button | | |
| 7 | Temperature up button | | |

Remote control

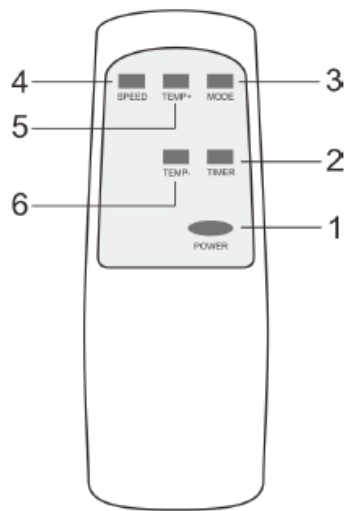

1	Power on/off
2	Timer on/off
3	Operation MODE
4	Fan speed
5	Temperature up
6	Temperature down

INSTALLATION







When the portable air conditioner is operating, the unit draws in indoor air and exhausts hot air out of the room to complete the air exchange.

CAUTION: The window kit must be installed before operating the unit.

When the unit is in FAN MODE, no outdoor air exchange takes place. The window kit and exhaust to not need to be installed when the unit is used as a fan.

Note: The supplied window kit can be installed in sliding windows and sliding glass doors.. When installed, be sure to keep the exhaust hose short and straight as possible for maximum efficiency.

WINDOW KIT

Part	Description
	Flexible air exhaust hose
	Exhaust hose connector (window end)
	Exhaust hose connector (housing adaptor) (air conditioner end)
	Adjustable window slider (for 67.5cm - 123cm windows)
	2 Dowels
	2 AAA-size batteries (packaged separately)

INSTALLATION (Cont.)

Please follow the below steps in order to setup your portable air conditioner.

Fit the exhaust hose and housing connectors to the ends of the flexible air exhaust hose, twisting them into place

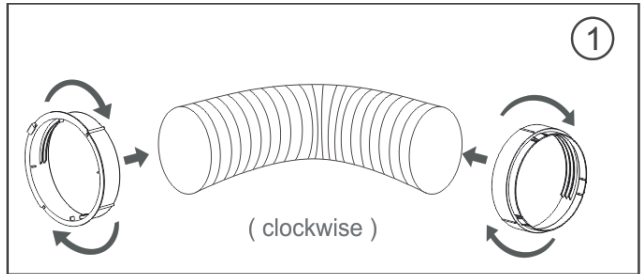

Insert the fixing clip of the housing connector into the openings at the back of the air conditioner.

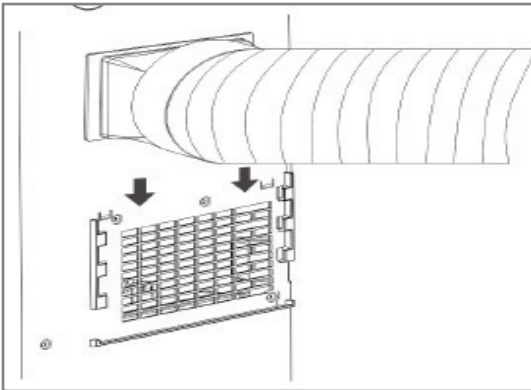

For temporary installation (in fan mode only), lead the exhaust hose connector (window end) out of an open window.

NOTE: Ambient air will still be able to enter the room this way. To cool the room effectively, the window kit must be properly installed.

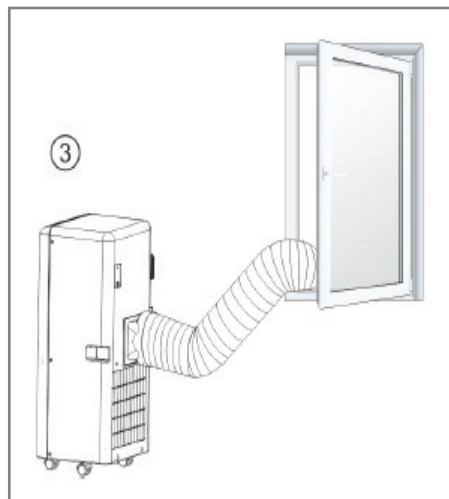

INSTALLATION (Cont.)

Installing the window kit

Your window kit has been designed to fit most standard 'horizontal' and 'vertical' window applications, but for certain types of windows it may be necessary for you to improvise/modify some aspects of the installation procedure.

Adjust the window slider to the length of a horizontally (or height of a vertically) opening window and fix it with a dowel.

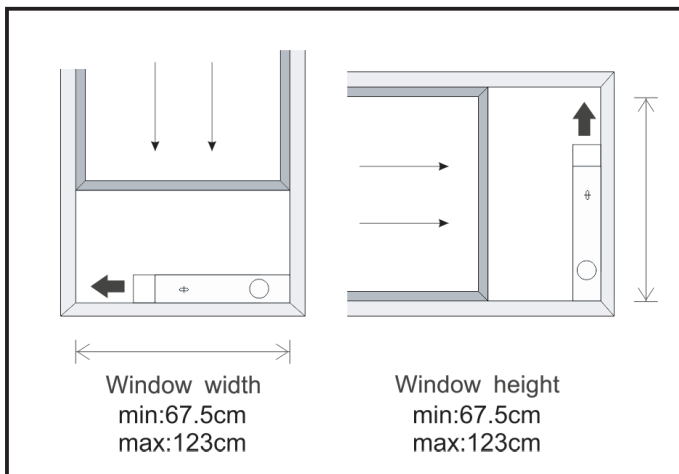

- Fit the slider to the bottom of the window sill (or to the side of the window, if it opens vertically), then close the window.
- Fit the exhaust hose connector (window end) through the opening to the outside.

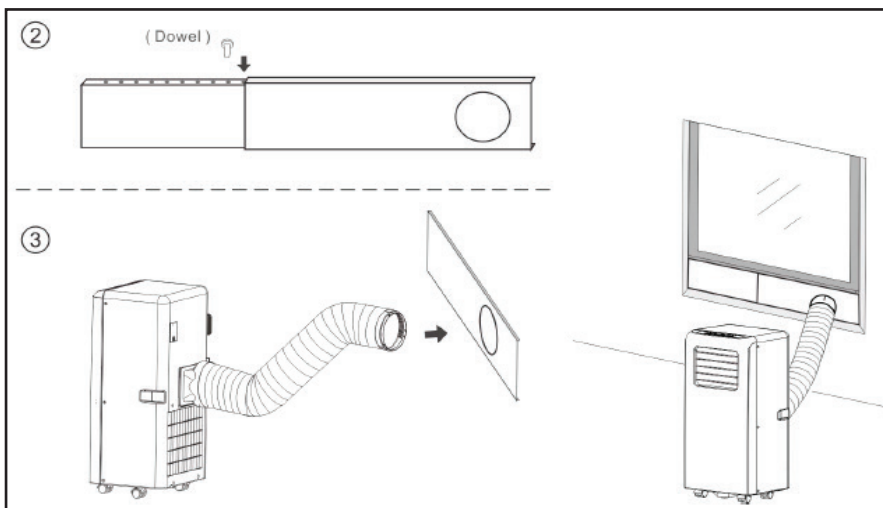

INSTRUCTIONS

Using the portable air conditioner

- Before switching the unit on for the first time, make sure you have properly installed the exhaust hose and window kit inserted two AAA size batteries into the remote control.
- Find a place for the air conditioner where there is a power outlet nearby.

Install the exhaust hose through the window kit so that the hot air is expelled to the outside.

Ensure the rubber stoppers at the back of the appliance are properly in place to block the drainage outlets.

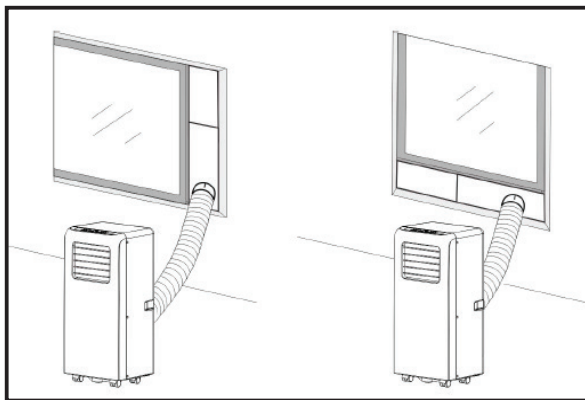

- Press the POWER button and the unit will start operation.

IMPORTANT INFORMATION

- As the compressor is inside the room, a portable air conditioner makes more noise than a split system, where the compressor is outside.
- For best cooling efficiency, keep blinds and curtains closed during the sunniest part of the day. Close off any fireplace damper, floor and/or wall register so cool air does not escape through the chimney or duct work.
- After switching on, allow 30 seconds for cool air to flow through the louvers. Avoid starting the air conditioner soon after switching off, and avoid switching it off immediately after switching on. Allow at least 3 minutes in between switching the unit on and then off, or vice versa.

INSTRUCTIONS (Cont.)

Cooling Mode

- Press the MODE button until the cooling mode indicator illuminates.
- Press the DOWN (-) or UP (+) button repeatedly to set the desired room temperature between 16°C and 31°C.
- Press the SPEED button to select the fan speed: high or low.

NOTE: For best cooling efficiency, make sure that:

- * Curtains/blinds are closed if your room is directly exposed to the sun.
- * The air conditioner is located away from any heat source.

Dehumidifying mode

- Press the MODE button until the dehumidifying mode indicator illuminates.
- The unit will automatically set the fan motor to low speed and maintain the room temperature at 2°C lower than the current room temperature (within the 16°C to 31°C range).

Fan mode

- Press the MODE button until the fan mode indicator illuminates.
- Press the SPEED button to select the fan speed high or low.

Timer Operation

- The air conditioner has a 24 hour timer, which you can set to start the unit at a later time, or to switch off the unit automatically.

On-Timer Setting

- With the unit switched off (but power supplied), press the TIMER button and then use the UP and DOWN buttons to select the number of hours after which you want the unit to turn on.
- Preset ON Time is displayed on the control panel.

Off-Timer Setting

- Use the same procedure as above, but while the unit is switched on, to set an auto-off time.
- Preset OFF Time is displayed on the control panel.

INSTRUCTIONS (Cont.)

Water Full Alarm

Condensation water that forms during cooling will drop into an in-built drip tray. When the water level in the drip tray is getting too full, an automatic water level sensor illuminates the Water Full indicator on the control panel to alert you that the drip tray needs to be emptied.

- Place a pan under the water drainage outlet at the bottom of the unit.
Alternatively, attach a water drain hose (not supplied) to a drainage outlet.
- Remove the respective rubber stopper and drain all water out of the tray.

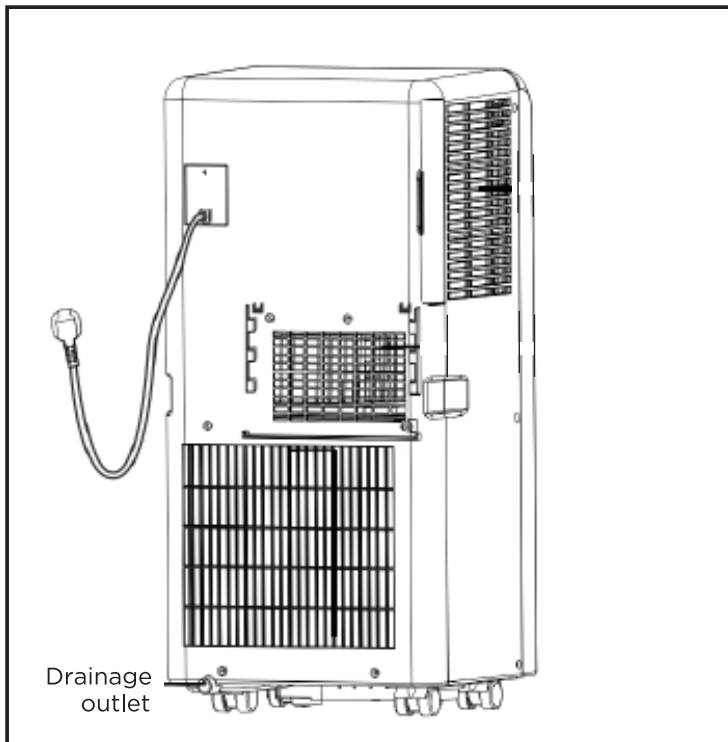

CLEANING & MAINTENANCE

Electric shock hazard!

Before cleaning and servicing, ensure the unit is switched off and disconnected from the power outlet to prevent possible injury.

Cleaning the air conditioner

Wipe the housing with a damp cloth, moistened with water and a little mild detergent. Dry with a soft, dry cloth.

CAUTION: Do not wash the unit directly. Do not use any solvent or alcohol based cleaning agent on any surface. Using such harsh cleansers will scratch or damage the surface, or can even lead to deformation of the housing.

Cleaning the air filter

This unit has an air intake filter at the back of the unit. If the air filter clogs up with dust, the airflow volume will be reduced. We recommend cleaning the filter once every two weeks.

To remove the filter, follow below:

- Open the air inlet grille and take off the air filter.
- Clean the air filter with a mild detergent in lukewarm water (max. 40 °C). Rinse thoroughly.
- Let all parts dry completely in the shade before reinstallation.

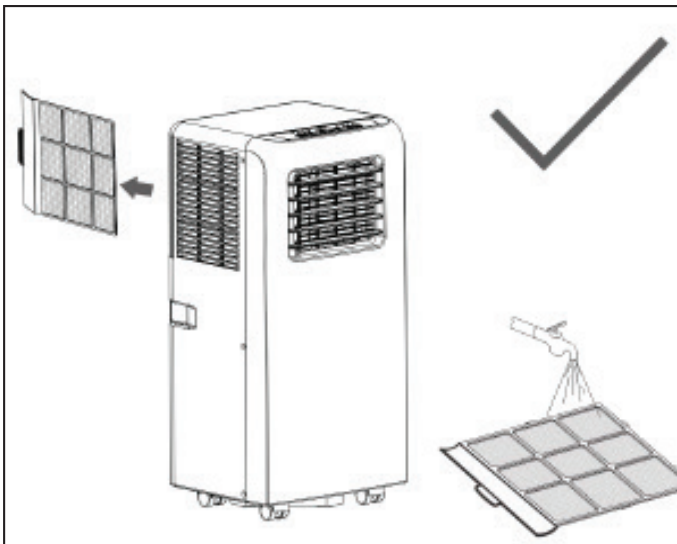

TROUBLESHOOTING

If you experience problems with your portable air conditioner, or it appears not to be operating correctly, check the information below for solutions to common problems. If none of the solutions offered help you solve your problem, please contact our support centre for advice on info@ayonz.com

Do not attempt to repair the appliance yourself!

Problem	Possible Causes	Solution
Unit does not start when pressing the POWER button.	The water full (FULL) indicator blinks, indicating that the drip tray is full.	Drain the condensation water manually.
	The room temperature is lower than the set temperature.	Reset the temperature.
Low cooling performance.	Doors or windows to the room are open.	Ensure all windows and doors to the room are closed.
	There are heat sources inside the room.	Remove the heat sources, if possible.
	The exhaust air hose is not connected, or blocked.	Connect or clean the exhaust air hose.
	The set temperature is too high.	Reset the temperature.
	The air inlet is blocked.	Clean the air inlet.
Noisy	The ground is not level or not flat enough.	Make sure to place the unit on a flat, level ground.
	The sound comes from the refrigerant flowing inside the air conditioner.	This is normal and no cause for concern.
E0 Code	The room temperature sensor failed.	Call for service to replace the part (the unit can also work without replacement).
E1 Code	Condenser temperature sensor failed.	Call for service to replace the part.
E2 Code	Water drip tray is full.	Drain the water manually out of the drip tray.
E3 Code	Evaporator temperature sensor failed.	Call for service to replace the part.

SPECIFICATIONS

Power Supply	220-240V ~ 50Hz	
Rated Power	POWER	710 W
	CURRENT	3.2 A
Capacity	COOLING	1900W (1.9 kW)
Weight	NET	20 kg
	GROSS	22.6 kg
Indoor Dishcharge Air-Flow	DISCHARGE	≥ 320m3/h
Refrigerant Type	TYPE	R290
	QUANTITY	140 g
Noise Level	≤ 66dB(A)	
Dimensions	UNIT	330 (w) x 280 (d) x 690 (h) mm

This appliance has been fully tested and meets all requirements as set out by standards AS/NZS 60335.1 and AS/NZS 60335.2.40.



CUSTOMER HELPLINE:

info@ayonz.com

DISTRIBUTED BY:

AYONZ PTY LTD