

GER✕ANICA

40CM PEDESTAL FAN KF16



INSTRUCTION MANUAL

Please read this manual carefully before using, and keep it for future reference.

CONTENTS

General Safety	4
Before first use	6
Product Overview	7
Getting Started	
Assembling the Stand	8
Assembling the Fan	9
Operating Instructions	10
Customer Support	12

GENERAL SAFETY

Read this manual thoroughly before you start using the Fan.

Store this manual, the completed warranty card, your receipt and the product packaging.

The safety precautions instructions reduces the risk of fire, electric shock and injury when correctly complied to.

Please follow all instructions and take notice of all warnings.

IMPORTANT INFORMATION

- Do not expose this product to rain or moisture as it may result in fire.
 - Do not temper or change or modify the product in any way.
 - Only use Accessories outlined and recommended by the manufacturer.
 - Please do not expose the product to splashing or water contact
-
- The apparatus shall not be exposed to dripping or splashing and no objects filled with liquids, such as vases, shall be placed on the product. Dry location use only.
 - No naked flame source, such as candles, should be placed on the product.
 - Do not operate the fan while power cord is coiled up, please completely unwind the power cord before using.
 - Do not allow power cord to hang over edge of table or bench.
 - Never move the fan by the power cord.
 - Move the power cord away from pathways of persons so they do not trip.
 - Do not run power cord under carpeting or cover it with rugs. Must have quick access to unplug the fan.
 - Do not use this fan with an extension cord, power adaptors or external timers.
 - This product is not designed for commercial, industrial or outdoor use.
 - Do not leave the fan unattended during use. Always switch off and unplug.
 - Children must be supervised at all times while in use. This fan is not a toy. Make sure children do not go near or attempt to play with this fan.
 - **AIRFLOW** - Make sure nothing is obstructing or blocking the airflow outlet at the front of the fan, and the airflow intake which is the back of the fan.
 - Do not insert an foreign objects into the fan grill opening as this may cause damage to the appliance and lead to electric shock and/or a fire hazard.

GENERAL SAFETY (CONT.)

- If you notice any unusual odors or smoke around the unit, immediately disconnect the unit from the outlet and contact the service center. Failure to do so may result in fire or electric shock.
- When not using the unit for long periods of time or when you are moving the unit. Please disconnect the product from main power.
- Please beware that Dust could accumulate over time on the unit and cause it to generate heat and or deteriorate insulation, which in turn may result in an electrical fire.
- The product is not intended for use by persons (including children) with reduced physical, sensory or mental capabilities, or young children of any age, They must be supervised product by a person responsible for their safety.
- To maintain the product do not use any chemical or cleaning agent or wet cloth, please only ensure to utilize a dry cloth to wipe it down from marks or dust and only after unplugging the product from the power socket.
- Please ensure to contact our call center for any repair or service required for the products.

Please make sure upon positioning this product, the place is:

- Not wet or damp and Well ventilated.
- Placed on a stable surface to avoid product from tipping over.
- Away from direct sunlight or heaters.
- Away from splashes or food.
- Protected from excessive dust or grease.
- Do not place this equipment in a confined space such as a bookcase or similar unit. Allow 20cm above and 5cm spacing on both sides for proper ventilation.
- Do not place the Product near heat sources such as radiators, stoves or other audio visual equipment that produce heat.
- Do not place small metallic objects near the unit.
- Do not use or store flammable or combustible materials near the unit. Doing so may result in fire or explosion. Do not place any naked flame sources, such as lit candles, cigarettes or incense sticks on top of the product.

GENERAL SAFETY (CONT.)

Before first use

- Unpack the fan and accessories and ensure all parts of the product are undamaged and in good working order.
- Plastic wrapping can be a suffocation hazard for babies and young children, so ensure all packaging materials are out of their reach and disposed of safely.
- Unwind the power cord to its full length and inspect it for damage before each use. Do not use the product if it or its cord has been damaged or is not working properly. In case of damage, contact our after sales support line for advice on examination, repair or return of the damaged product.
- Ensure the fan is not exposed to direct sunlight or placed near a heater or other heat source.
- Placed on a flat and dry surface.
- Do not place in areas of high humidity such as bathrooms, laundry area, near a sink, washer or pool (any source of water).

PRODUCT OVERVIEW

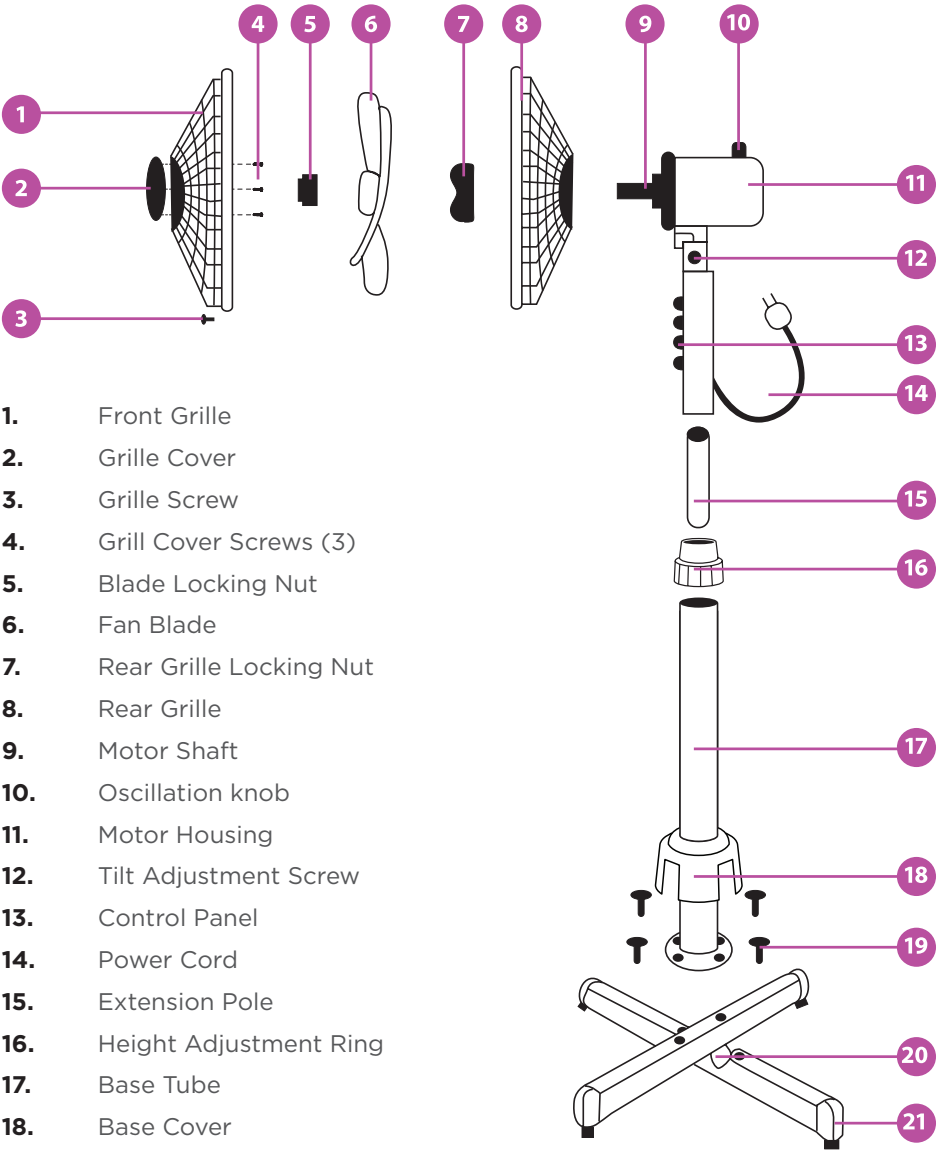

- 1. Front Grille
- 2. Grille Cover
- 3. Grille Screw
- 4. Grill Cover Screws (3)
- 5. Blade Locking Nut
- 6. Fan Blade
- 7. Rear Grille Locking Nut
- 8. Rear Grille
- 9. Motor Shaft
- 10. Oscillation knob
- 11. Motor Housing
- 12. Tilt Adjustment Screw
- 13. Control Panel
- 14. Power Cord
- 15. Extension Pole
- 16. Height Adjustment Ring
- 17. Base Tube
- 18. Base Cover
- 19. Base Screws (4)
- 20. Cross Base
- 21. End Caps (4)

Getting Started

ASSEMBLING THE STAND.

NOTE - use the illustration of Product Overview while following instructions.

1. Make a cross with the cross bases (20) by fitting them together at the center. The four end caps (21) will be pre-assembled to the end of the cross bases.
2. Loosen the four base screws (19) from the cross base and remove. Align the four holes on the bottom of the base tube (17) with the four holes in the cross base.
3. Insert the four base screws (19) into the aligned holes and tighten them completely.
4. Turn the height adjustment ring (16) and remove it.
5. Slide the base cover (18) down so that it covers the screw tops in the cross base.
6. Replace the height adjustment ring (16) but do not tighten.
7. Extend the extension pole (15) and secure it by tightening the height adjustment ring (16).

NOTE - If the extension pole is not readily visible, look inside the base tube (where it is located) and pull it to extend completely.

8. Attach the control panel (13) with the motor housing (11) assembly to the top of the extension pole (15).
9. Tighten the adjustment screw at the rear of the control panel to fix the control panel and motor assembly onto the extension pole (15).

Getting Started (Cont.)

ASSEMBLING THE FAN.

NOTE - use the illustration of Product Overview while following instructions.

1. Remove the rear grille locking nut (7) from the motor housing (11) by rotating it anticlockwise.
2. Insert the rear grille (8) onto the motor housing (11) and position it so that the locator posts on the motor housing align with the slotted holes on the rear grille.
3. Lock the rear grille into place with the rear grille locking nut (7) by tightening the nut clockwise till the rear grille sits securely against the motor housing (11).
4. Slide the fan blade (6) onto the motor shaft (9) until the grooves of the fan blade align with the pins of the motor shaft and the fan blade cannot be pushed back any further.
5. Screw in the blade locking nut (5) onto the end of the motor shaft and tighten by rotating it anticlockwise.
6. Attach the front grille (1) to the rear grille (8) by following the steps below:
 - The grille cover (2) will come pre-assembled onto the front grille (1).
 - Pull up the clamps on the front grille (1). Align the front and the rear grilles ensuring that the two small holes found on the bottom of the grilles line up.
 - Press down on the clamps ensuring the rim of both front and rear grilles are secured within the inside slot of the clamps and push down on the rim hook until it locks into place.
7. Insert the grille screw (3) into the aligned hole and tighten it using the supplied nut.
8. Place the Fan on a dry, flat stable surface. You are now ready for operation.



Operating Instructions

1. Once the Fan has been fully assembled plug the power cord into a power outlet and switch the outlet on.
2. Select the desired speed with the control panel:
 - 0 - Off
 - 1 - Low speed
 - 2 - Medium speed
 - 3 - Maximum speed
3. To turn the Fan off, press the “0” button and then switch off and remove the plug from the socket.

OSCILLATION

Press the oscillating knob (10) down to activate. To stop the motion and keep the Fan still, pull the oscillation knob up.

TILT

Adjust the tilt angle and by tilting the head of the Fan. You will hear the Fan click into one of the 3 available positions.

This page is left
blank intentionally.



CUSTOMER HELPLINE:

info@ayonz.com

DISTRIBUTED BY:

Ayonz Pty Ltd