

GERMANICA

2000W

CARBON FIBRE WALL HEATER

GHO2000CWB-2

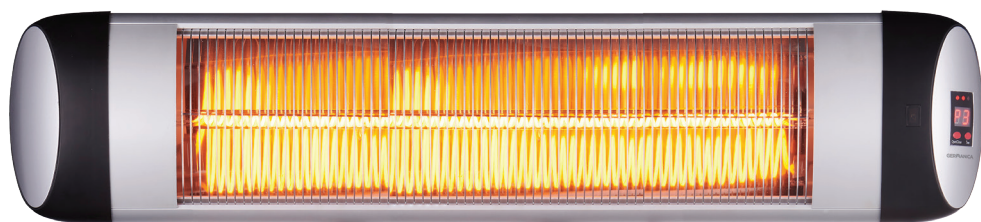

INSTRUCTION MANUAL

Please read this manual carefully before using, and keep it for future reference.

CONTENTS

General Safety	4
Remote Control	8
Product Overview	9
Installation	10
Operation	12
Cleaning and Maintenance	15
Troubleshooting	Last Page
Specifications	Last Page
Customer Helpline	Last Page

GENERAL SAFETY

Read this manual thoroughly before you start using the heater.

Store this manual, the completed warranty card, your receipt and the product packaging. The safety precautions instructions reduces the risk of fire, electric shock and injury when correctly complied to.

Please follow all instructions and take notice of all warnings.

Please follow instruction when installing this product in accordance with the instruction manual.

- Before installing this product, make sure your outlet voltage corresponds to the voltage stated on the product rating label
- Do not use a damaged power cord, plug or loose outlet. Doing so may cause an electric shock.
- Do not plug several devices into the same outlet. Doing so may cause the outlet to overheat and start a fire. Make sure the outlet is readily accessible during operation of the equipment.
- Do not bend, twist or kink the power cord excessively.
- Do not allow anything to rest on or roll over the power cord. Doing so may cause a fire or an electric shock.
- Do not run the power cord near heat-producing appliances such as radiators, stoves or irons. The excessive heat could melt the insulation and expose live wires, resulting in fire or electric shock.
- Do not expose this product to water. The electrical insulation could be damaged and cause electrocution. Do not touch the unit when barefoot or parts of your body are wet or damp.
- This appliance is not intended for use by persons (including children) with reduced physical, sensory or mental capabilities, or lack of experience and knowledge, unless they have been given supervision or instruction concerning use of the appliance by a person responsible for their safety.
Children should be supervised to ensure that they do not play with the appliance.
- If the supply cord is damaged, it must be replaced by the manufacturer, its service agent or similarly qualified persons in order to avoid a hazard.
- This appliance is intended for heating indoor domestic environments. It is not suitable for commercial, industrial or trade use. Do not use it for any other purpose (such as drying clothes, etc.), and only use it as described in this manual.
- Please regularly cleaning the reflector

GENERAL SAFETY INSTRUCTIONS (Cont.)

- Do not cover the ventilation openings of the product with items such as newspapers, tablecloths, curtains etc or insert objects into the slots available on the products. As this could result in the product temperature rising and could cause a fire.
- If you notice any unusual odors or smoke around the unit, immediately disconnect the unit from the outlet and contact the service center. Failure to do so may result in fire or electric shock.
- When not using the unit for long periods of time or when you are moving the unit please ensure to disconnect the power supply from the wall socket.
- Please beware that Dust could accumulate over time on the unit and cause it to generate heat and or deteriorate insulation, which in turn may result in an electrical fire.
- Batteries from the remote control must be only removed by an adult, the adult must ensure to keep them out of reach of infants and children. Seek medical attention immediately if a child has swallowed a battery.
- To maintain the product do not use any chemical or cleaning agent or wet cloth, please only ensure to utilize a dry cloth to wipe it down from marks or dust and only after unplugging the product from the power socket.
- Please ensure to contact our call center for any repair or service required for the products not doing so will make warranty on your product void.
- We assume no liability for any eventual damages to property or injury to persons caused by misuse of the product or noncompliance with these instructions.

Please make sure upon positioning this product, the place is:

- Not wet or damp and Well ventilated
- Away from splashes or food.
- Away from direct sunlight or heaters.
- Protected from excessive dust or grease.
- Do not place containers with liquids, if liquid falls inside the products it may result in short-circuit, fire or electric shock.
- Do not place small metallic objects on top of the unit or block the openings as it will reduce operating efficiency of the air con with failures or damages.
- The appliance shall under no circumstances, be covered with insulating material or similar material.
- The heater must not be located immediately below a socket outlet.
- The heater is to be installed so that switches and other controls cannot be touched by a person in the bath or shower.

GENERAL SAFETY INSTRUCTIONS (Cont.)

- **WARNING: Do not cover!** Do not cover the heater or obstruct any air inlet or outlet grilles. Obstructing these openings causes a fire hazard, reduces the operating efficiency and may lead to malfunction or damage.
- Do not insert any objects, or your fingers, into the air outlet, and make sure to warn children of the dangers. Keep ventilation openings clear of obstructions.
- Supervise children to ensure they do not play with the appliance. Close supervision is necessary when any appliance is used by or near children. Cleaning and user maintenance shall not be made by children without supervision.

DO NOT INSTALL/USE THE APPLIANCE IN THE FOLLOWING AREAS:

- outdoors or where water is likely to splash
- in an area where oil is likely to splash
- near a hot gas or electric burner, or sources of fire
- near sources of heat, or exposed to direct sunlight
- in an area where furniture or other objects can obstruct the airflow
- in the presence of flammable substances or vapour such as alcohol, insecticides, petrol, etc.
- at a dry cleaner's premises.

GENERAL SAFETY INSTRUCTIONS (Cont.)

- **DO NOT** place near any combustable materials, such as fabrics, blankets, curtains, etc. May result in catching on fire or burning.
- We accept no responsibility for any eventual injuries or damages caused by improper installation, faulty use or failure to follow the instructions.

WARNING:

- Do not expose the appliance to high heat, sparks and open flames.
- Do not pierce or burn the appliance.
- Maintenance must only be carried out by properly qualified, authorised personnel. If the appliance requires maintenance or service, contact our after sales support centre info@ayonz.com

Electric shock hazard!

Before installation, cleaning or or servicing, ensure the unit is switched off and disconnected from the power outlet to prevent possible injury.

CAUTION: Do not touch hot surfaces. The temperature of the outer body can get very hot while the product is in operation. Allow the unit to cool down completely before cleaning or packing the unit away for storage.

NOTE: You may notice a slight odour being emitted from the product during the initial use. This is normal and odour will cease with continued use.

REMOTE CONTROL

Using the Remote Control

- Do not mix old and new batteries in the remote
- Do not use different types of battery
- If you do not intend to use the unit for a long time, please remove batteries from the remote to avoid accident.
- Keep batteries away from children and pets.
- Never throw batteries into a fire.
- Do not drop, or impact the remote control as it void warranty immediately.
- The remote control operate at a range of 5 to 6M effectively
- Do not expose the remote control sensor to a bright light.

INSTALLING BATTERIES

1. Open the battery box on the back of remote control, and install 2 x AAA batteries (not included).
2. Make sure to match the battery polarities (+ / -) with the remote control compartment.
3. Put on the back cover.

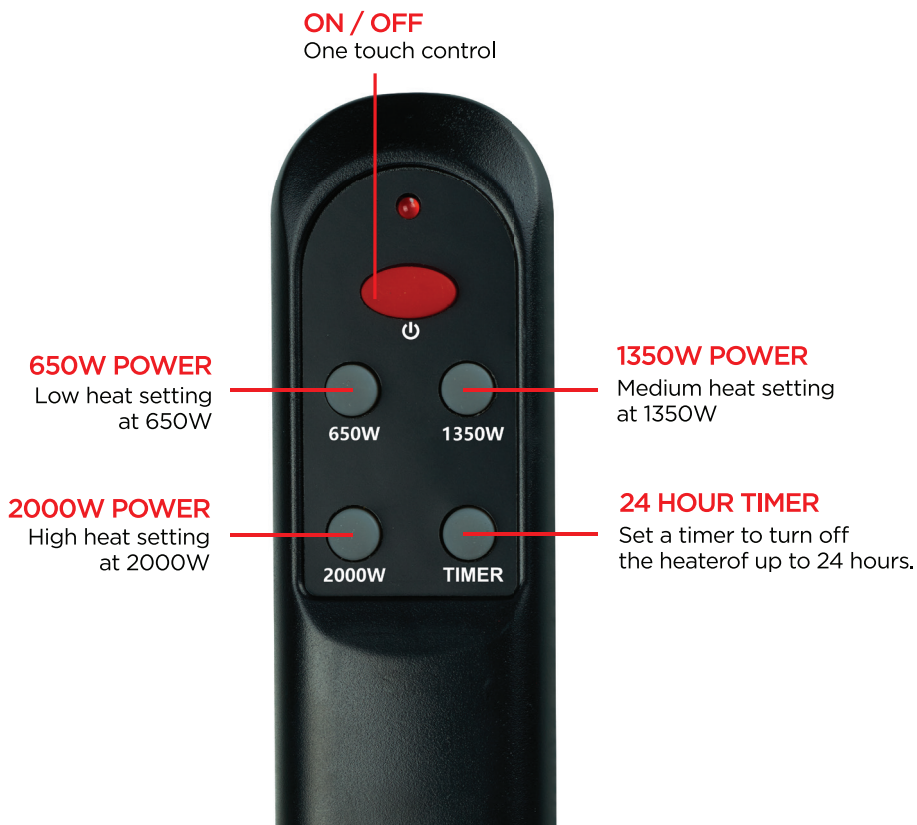

PRODUCT OVERVIEW

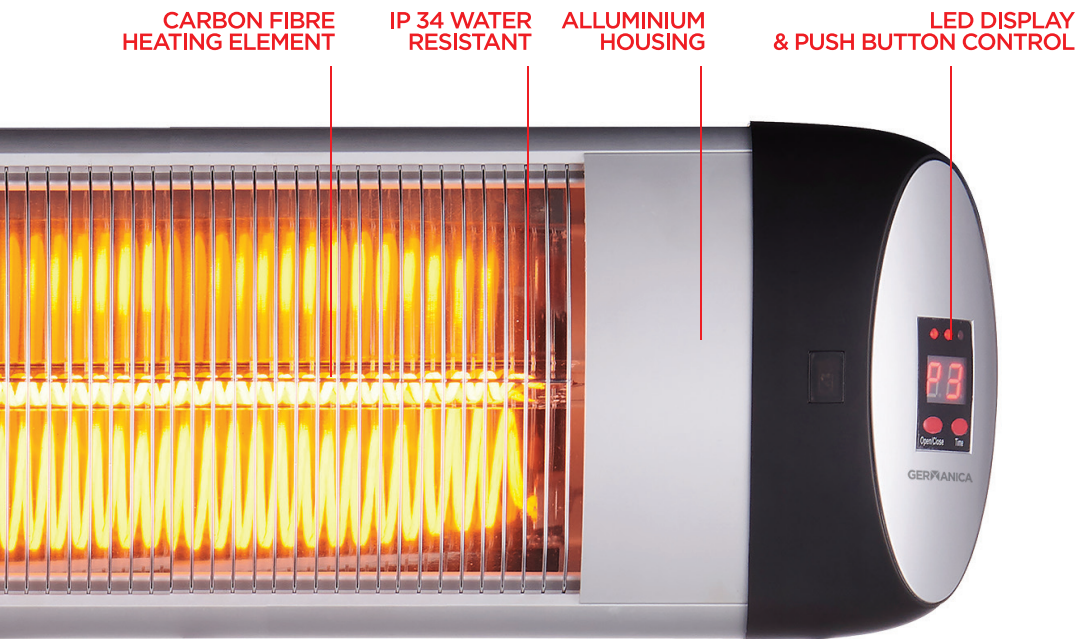

INSTALLATION

MAKE SURE TO INSTALL THIS PRODUCT IN HORIZONTAL POSITION

If this product is not installed at a horizontal position and level, with maximum of 5° slope variation otherwise heating loop wire may be damaged.

INSTALLAING THE BRACKETS (WALL MOUNTING)

1. There are 4 brackets and fasteners used with the heater. Furthermore, in the canal of back side of the heater there are 4 square fastener washers 25×25mm. Relieve square washers and fasten 2 brackets to the canal of the backside of the heater by the help of screws.

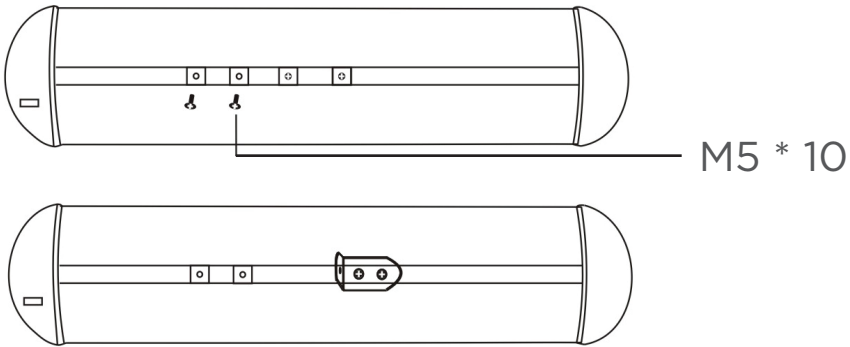

2. Fasten the brackets at the appropriate distance of each other (45-55cm).

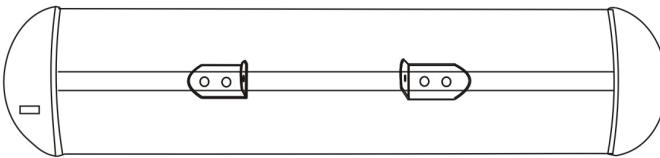

3. Two other brackets are fastened by the help of fasteners at the appropriate distance on the wall parallel to the floor (At least 1.8m from the floor and at least 0.5 m from the ceiling).

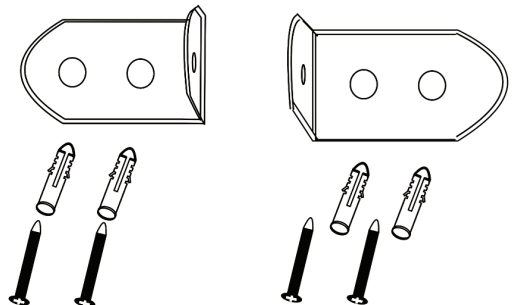

INSTALLATION (Cont.)

4. Join the brackets on the heater with the brackets fastened on the wall, with help of figured screw-nuts. Install the heater under necessary angle (in the direction to the area being heated). Look at issue 4:(Main rules of heater using).

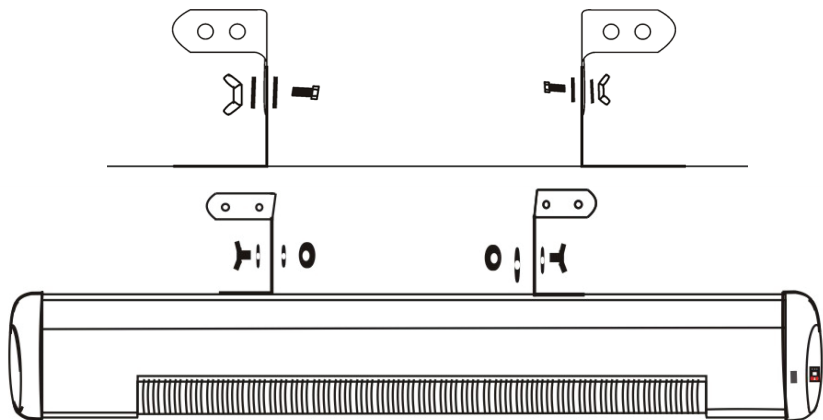

MAKE SURE TO INSTALL THIS PRODUCT IN HORIZONTAL POSITION

If this product is not installed at a horizontal position and level, with maximum of 5° slope variation otherwise heating loop wire may be damaged.

INSTALL HEATER IN STRICT HORIZONTAL POSITION

Parallel to floor.

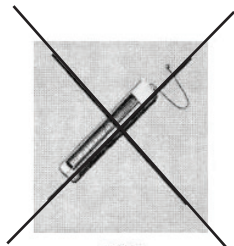

FALSE

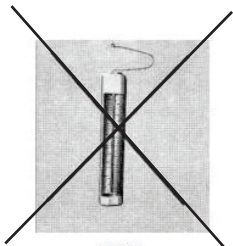

FALSE

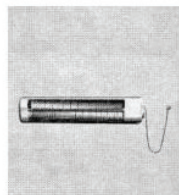

RIGHT

DIRECT HEATER AT THE APPROPRIATE ANGLE



FALSE



RIGHT



FALSE



RIGHT

OPERATION

1. Choose a suitable and safe position for the heater.
2. Plug the power cord into the socket.
3. Press rocker power switch to "--" position and the switch indicator light will be on, indicating power on.

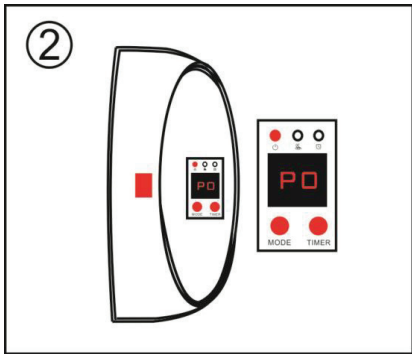
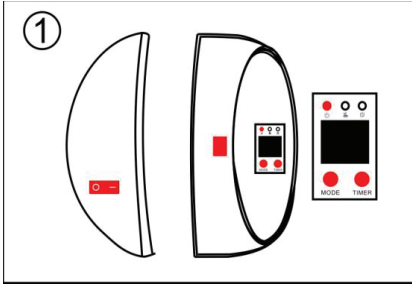

4. Press MODE once, the digital screen shows "P 1" which means first power setting is on.

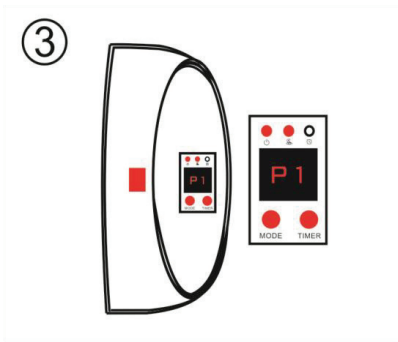

OPERATION (Cont.)

5. Press MODE two times, the digital screen shows "P 2" which means second power setting is on.

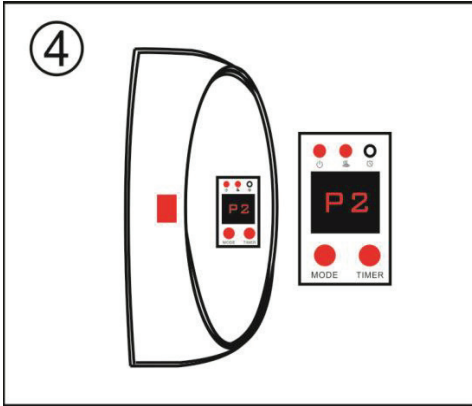

6. Press MODE three times, the digital screen shows "P 3" which means third power setting is on.

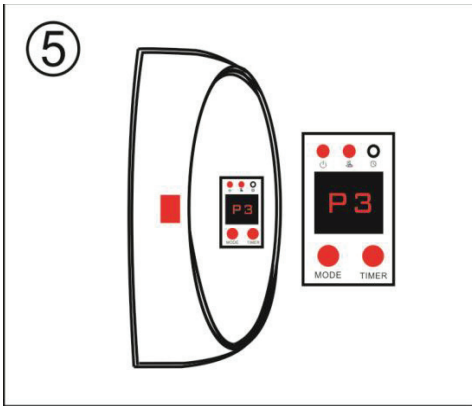

OPERATION

- After pressing TIMER to set the timer shut off time, 1-24 hours timing can be adjusted. The digital screen will display "0 1" indicates timing one hour, "0 2" indicates timing two hours, etc.

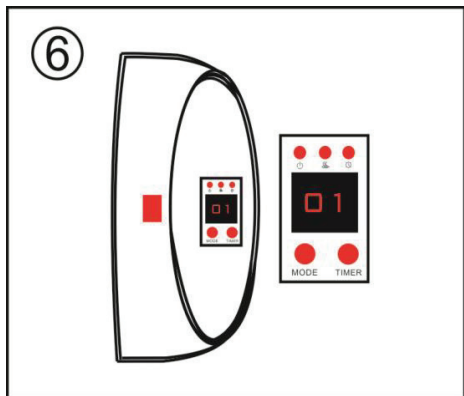

CLEANING & MAINTENANCE

Electric shock hazard!

Before cleaning and servicing, ensure the unit is switched off and disconnected from the power outlet to prevent possible injury.

Cleaning

1. Before undergoing maintenance, please disconnect the power cord plug out the power source, can be carried out after 10 minutes cooling down.
2. Clean the surface area of dust, with a soft cloth to wipe; When the surface is too dirty, make sure use warm water though below 50 degrees Celsius of the mixture of water and neutral detergent. Touch water with cloth to wipe and be sure to dry with another cloth.
3. Do not use while clean gasoline, days that water, diluent and any easy to damage the surface material; Because these may react with heater and cause discoloration.
4. Product when not in use for a long period of time, unplug the power plug, if just finished using the heater let it cool down for 15 minutes. Wrap the machine to prevent dust into the machine.
5. When the heater should be cold, dry, packaged storage and dry ventilated place, as this may damage the appliance.
6. In case of breakdown and/or poor functioning of the appliance, disconnect the appliance from the power supply and contact an authorized repairer.

TROUBLESHOOTING

If you experience problems with your product, or it appears not to be operating correctly, please contact our support centre for advice on info@ayonz.com

Do not attempt to repair the appliance yourself!

SPECIFICATIONS

Rating	220-240V ~ 50/60Hz, 2000W (IP34)	
Weights	NET	2.8 kg
	GROSS	3.5 kg
Dimensions	930 (w) x 95 (d) x 195 (h) mm	



CUSTOMER HELPLINE:

info@ayonz.com

DISTRIBUTED BY:

AYONZ PTY LTD